

January 15, 2020



# ENVISIONING THE NEW WEST ELEMENTARY SCHOOL



## The Visioning Process

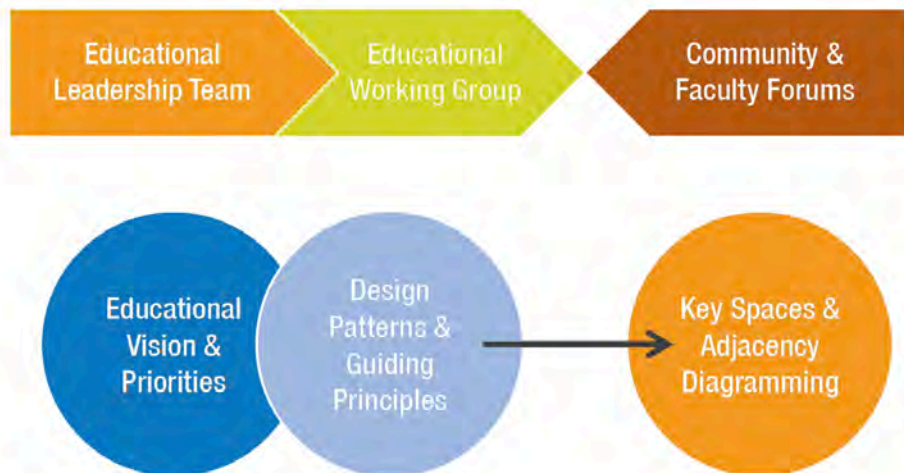



# Blue Sky Ideas

What no-holds-barred, over-the-top, aspirational idea(s) and/or space(s) would you like to see take shape in the new and/or renovated facility?



# Bubble Diagramming of Key Spaces and Adjacencies

# Working with the MSBA Template

The image shows a screenshot of a spreadsheet application with a window titled "Proposed Space Summary- Elementary Schools". The spreadsheet is organized into several columns and rows. The first column is labeled "FILL IN SCHOOL NAME HERE". Subsequent columns include "Room Name", "Room Type", "Area", "Volume", "Count", "Total Area", and "Total Volume". The rows are grouped into sections for different school levels: "Elementary", "Middle", and "High". Each section contains a list of room types such as "Classroom", "Teacher Office", "Lab", "Commons", and "Hub", with corresponding numerical values in the other columns. The spreadsheet is filled with green and white cells, and there are some handwritten notes and formulas visible.

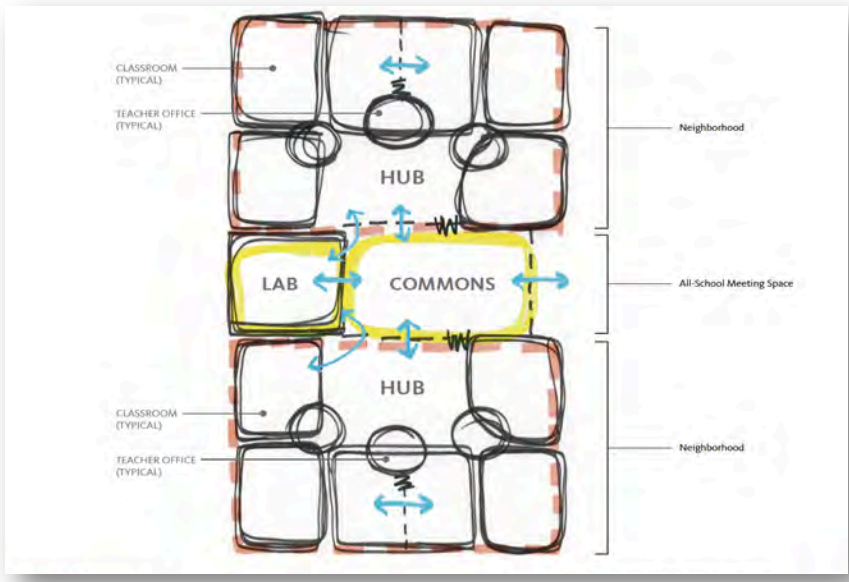

# Community Access

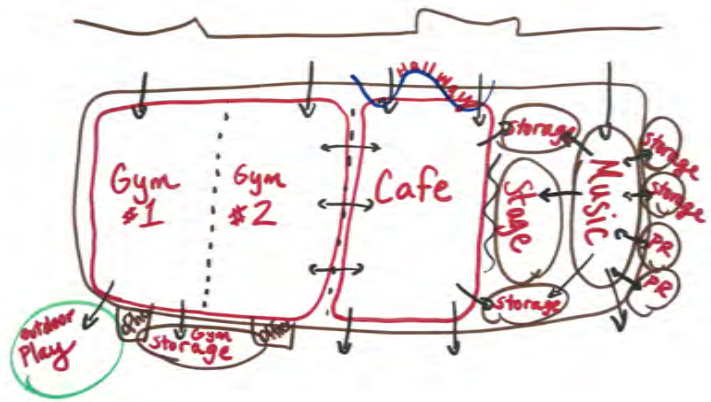

# Classroom Neighborhood

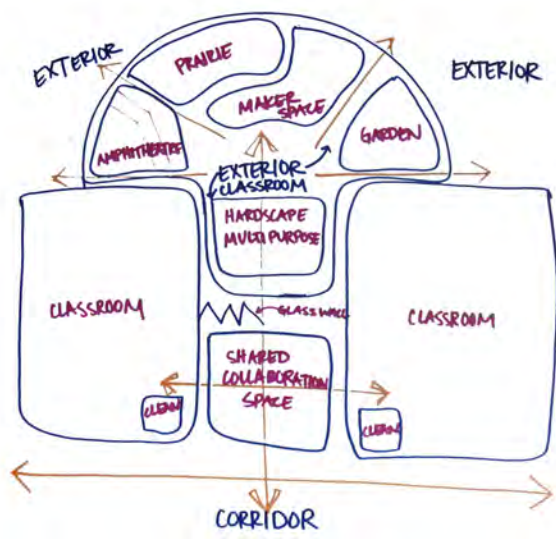

# Whole School Diagram

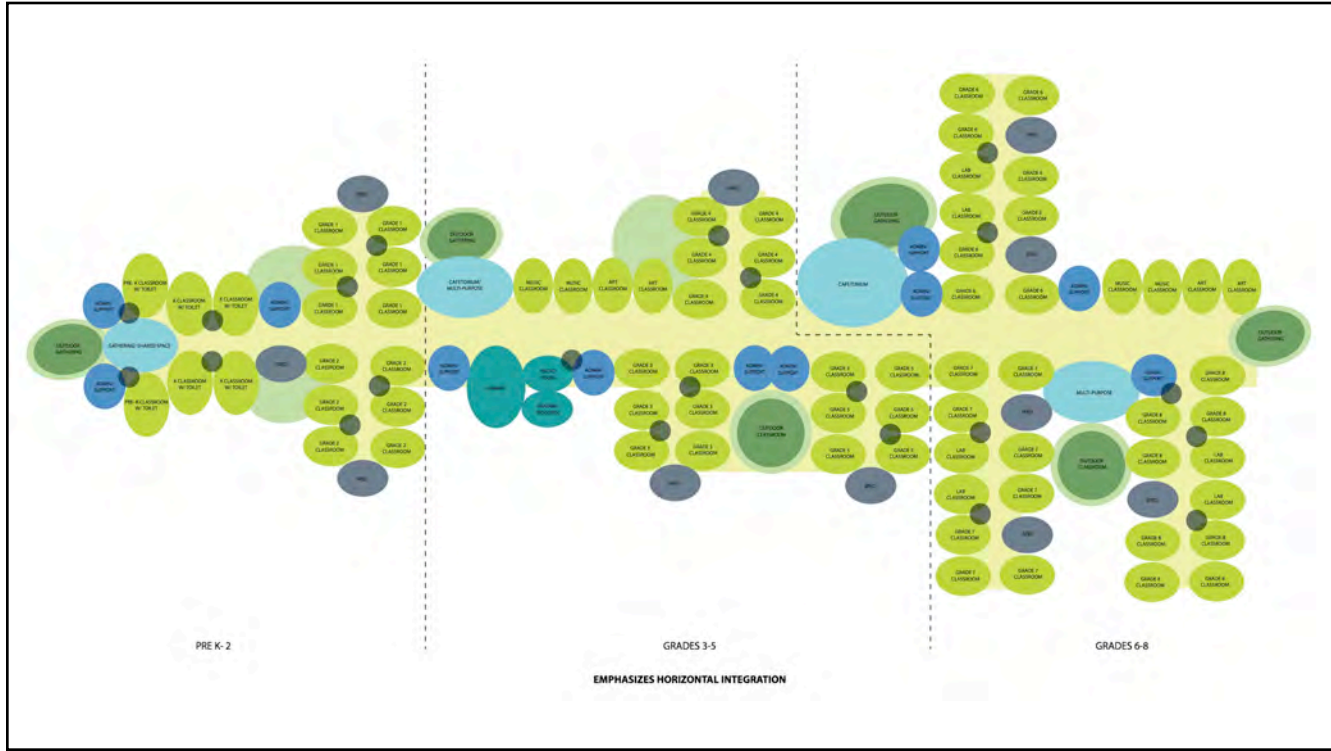
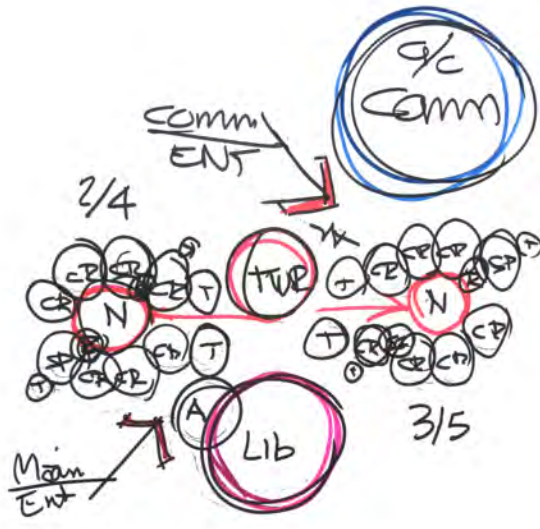

# Community Access

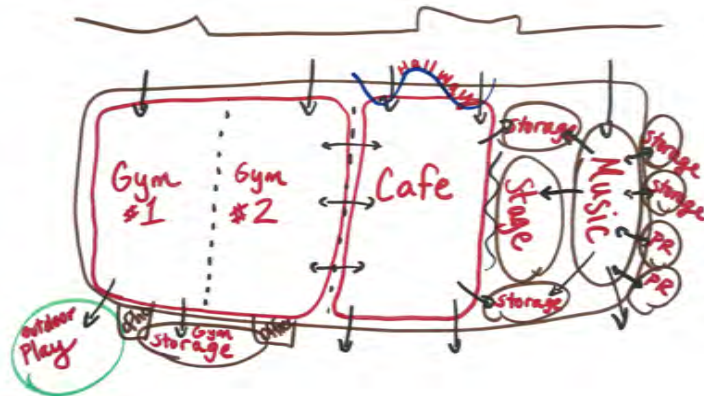

# Classroom Neighborhood

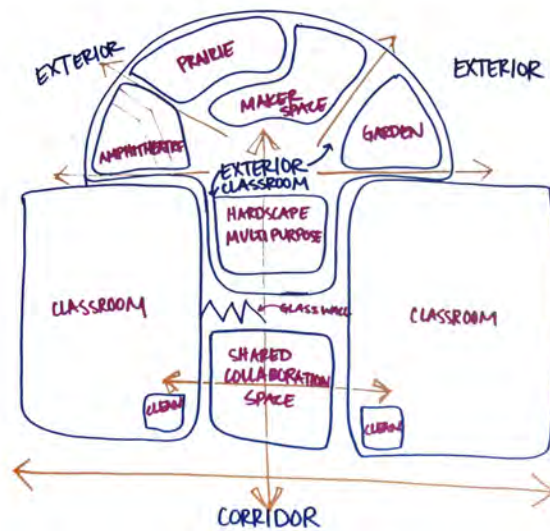

# Whole School Diagram

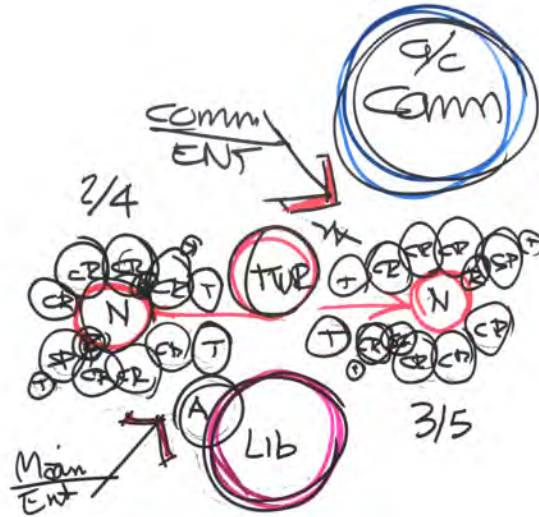

## Talking Points for the Community